



Part Number : [638514100](#)

Product Description : T2 Terminator Die

Series Number : 207122

Status : Active

Product Category : Applicators and Crimp Modules

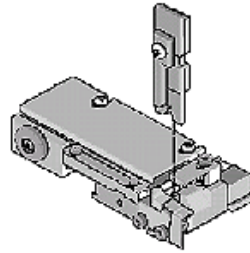

Documents & Resources

Tooling Specifications

[638514100-001.pdf](#)

[TM-638000029-001.pdf](#)

[TM-638000029DE-001.pdf](#)

[TM-638000029SP-001.pdf](#)

[TM-638000029FR-001.pdf](#)

[TM-638000029IT-001.pdf](#)

[TM-638000029JP-001.pdf](#)

[TM-638000029KR-001.pdf](#)

[TM-638000029MY-001.pdf](#)

[TM-638000029PL-001.pdf](#)

[TM-638000029RU-001.pdf](#)

[TM-638000029SK-001.pdf](#)

[TM-638000029TH-001.pdf](#)

[TM-638000029VN-001.pdf](#)

[TM-638000029CN-001.pdf](#)

[TM-638000029TW-001.pdf](#)

[TM-638500090-001.pdf](#)

[TM-638500090SP-001.pdf](#)

Product Environment Compliance

Compliance

GADSL/IMDS	Not Relevant
China RoHS	Not Relevant
EU ELV	Not Relevant
Low-Halogen Status	Not Relevant
REACH SVHC	Not Reviewed per D(2024)4144-DC (27 June 2024)
EU RoHS	Not Reviewed per EU 2015/863

Multiple Part Product Compliance Statements

- Eu RoHS
- REACH SVHC
- Low-Halogen

Multiple Part Industry Compliance Documents

- IPC 1752A Class C
- IPC 1752A Class D
- Molex Product Compliance Declaration
- IEC-62474
- chemSHERPA (xml)

EU RoHS Certificate of Compliance

Part Details

General

Status	Active
Category	Applicators and Crimp Modules
Series	207122
Description	T2 Terminator Die
Function	Crimp
Geographic Area	Global
Level of Automation	Semi-Automatic
More Detailed Tech Information	toolingsupport@molex.com
Product Name	T2
Tool Type	Terminator Die
UPC	800754852555
Warranty Disclaimer	<p>CAUTION: Molex tooling crimp specifications are valid only when used with Molex terminals and tooling manufactured by Molex and sold by Molex or authorized distributors ("Molex Tooling"). When using tooling other than Molex Tooling with Molex specific connector systems listed in our ATS documents, the Molex tooling qualification does not apply and the responsibility for full qualification of the connector system is that of the customer. Molex accepts no liability for connector performance or tooling support where tooling other than Molex Tooling is used or where Molex Tooling is modified.</p>

Physical

Net Weight	837.026/g
------------	-----------

Use with Part(s)

Description	Part Number
3BF Base Unit	<u>11193001</u>

Applicable Parts

Description	Part Number
C-Grid III Female Crimp Terminal, 24-22 AWG, Reel, Tin (Sn)	<u>901190109</u>
C-Grid III Female Crimp Terminal, 24-22 AWG, Reel, 0.76µm Selective Gold (Au)	<u>901190111</u>
C-Grid III Female Crimp Terminal, 24-22 AWG, Reel, 0.38µm Selective Gold (Au)	<u>901190110</u>
